



YML01CR-NIxxF LENS



PRODUCT DESCRIPTION

Features:

- High efficiency >88%
- Available in 4 beam pattern
- Optimized for uniform effects
- Lens material Optical grade PC
- Lens without holder

Typical applications:

- Stage Lighting
- Street Lights
- Decorative Light
- Down Light

TABLE OF CONTENTS

General Information2
Usage and Maintenance2
2D Drawings 3-7
Optical Characteristics (for 3535 led) 3-7
Package Information8
Product Nomenclature9



General Information (T_J = 25°C)

- Compatible Led Type:

The YML01CR-NIxxF single lens is optimized for 3535 led .

- Beam Angle Type:

An optimized profile integrate different front shape enabel the general of four lens model:oval beam (15deg;30deg;45deg and 10*65deg)⁽¹⁾

- The Way to Assembly:

The lens should be assembled to the PCB board or MCPCB upon LEDs which provides the most appropriate related position,so as to achieve the best uniform results.

*** Manually installation or if necessary thermal glue are recommended.**

- Fuction:

YML01CR-NIxxF provides excep tional color mixing result with the highest efficiency through careful enginnering and precision manufacturing process.

Usage and Maintenance

- 1.Clean lenses with mild soap and water and a soft cloth.
- 2.Don't use any commercial cleaning solvents on lenses,like alcohol.
- 3.Operating temperature -40℃~+110℃(upper limit +120℃)
- 4.please handle or install lenses with wearing gloves,skin oils may damage lens or optical characteristic.

Notes:

(1) Typical beam divergence will be affected by different LED manufacturers.



2D Drawings (unit:mm)

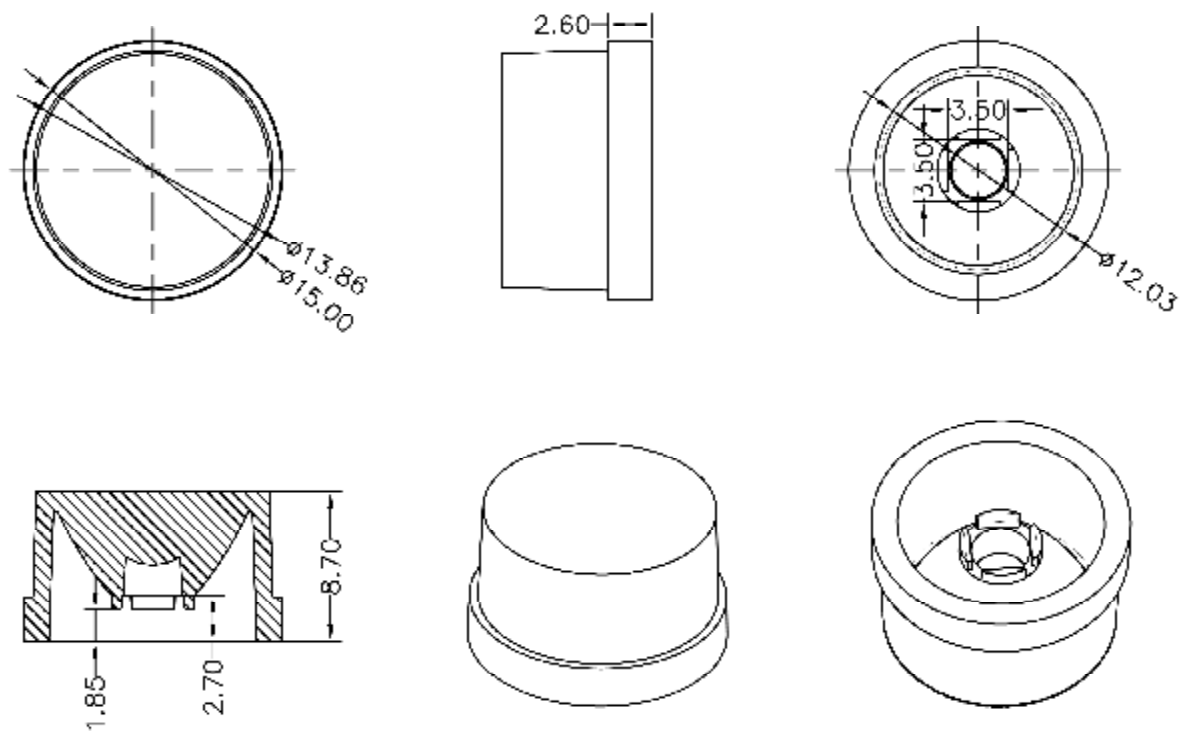

LENS

Optical Characteristics (for 3535 LED)

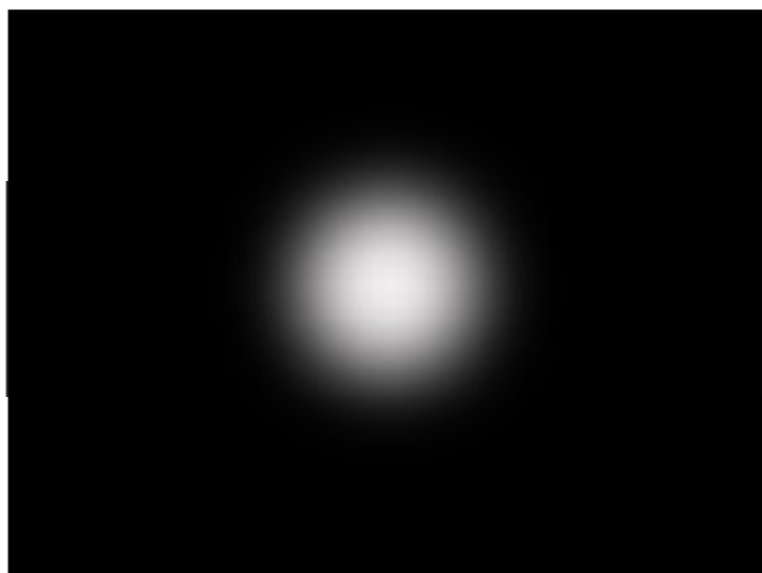
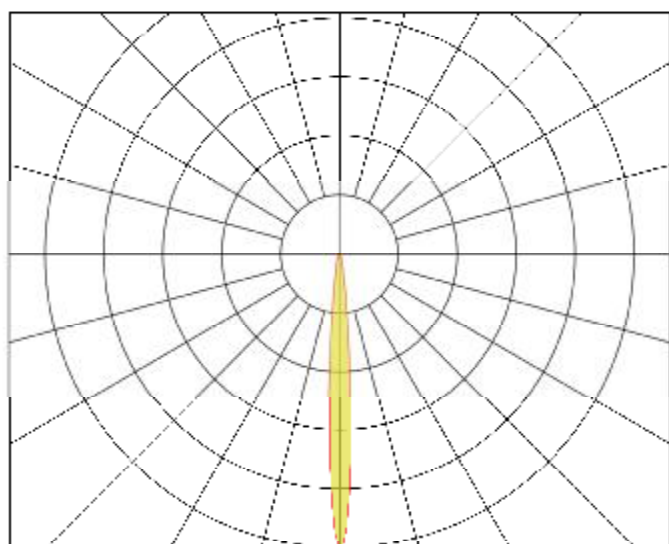

Note: The LED emitter flux is 120lm @350mA



2D Drawings (unit:mm)

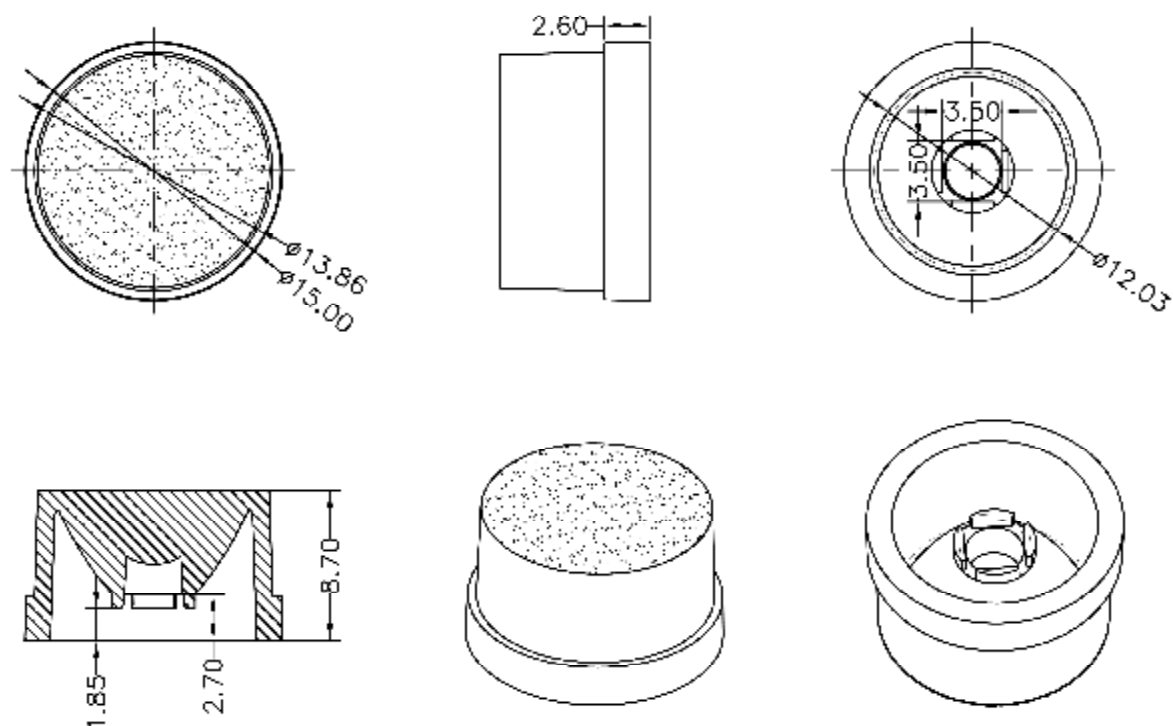

LENS

Optical Characteristics (for 3535 LED)

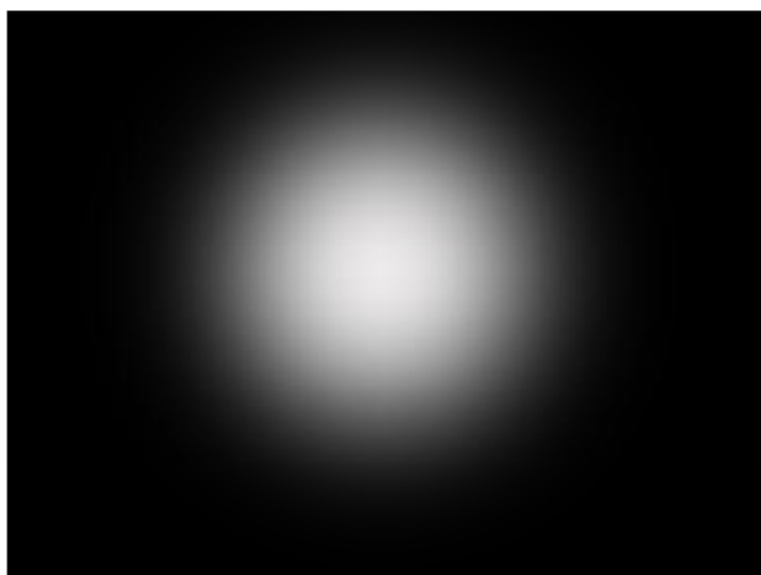
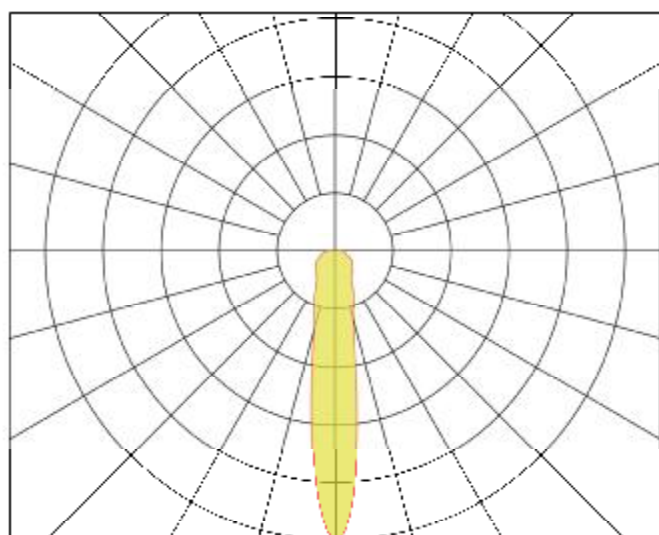

Note: The LED emitter flux is 120lm @350mA



2D Drawings (unit:mm)

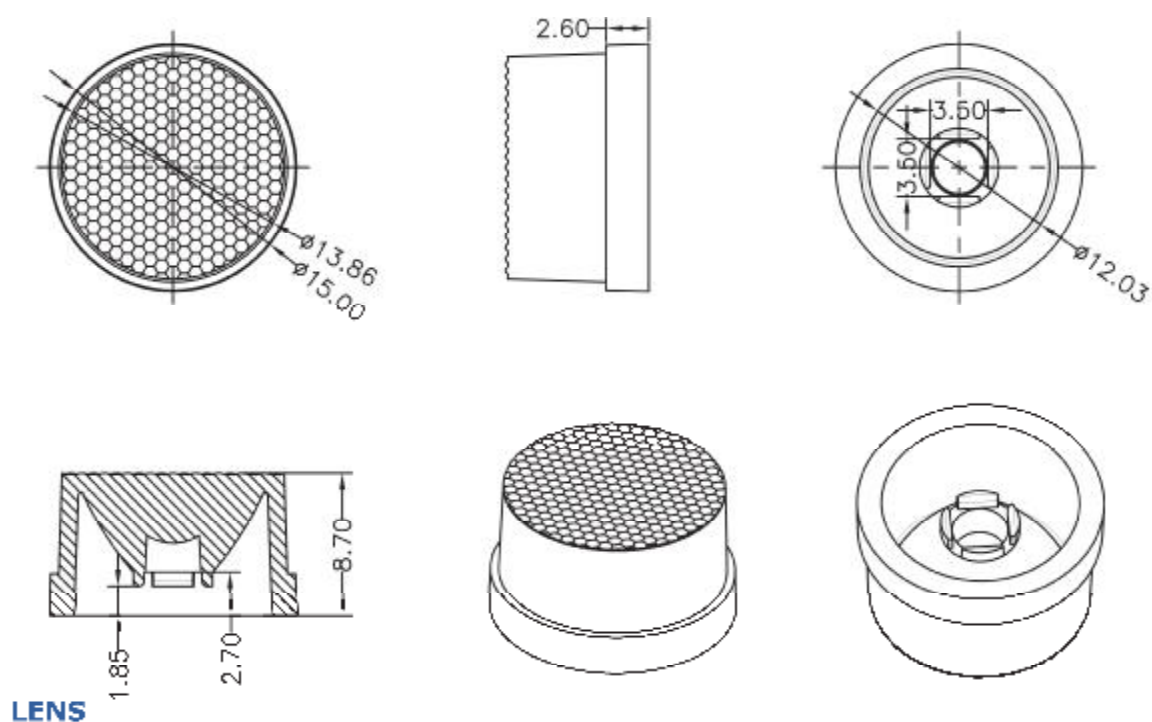

Optical Characteristics (for 3535 LED)

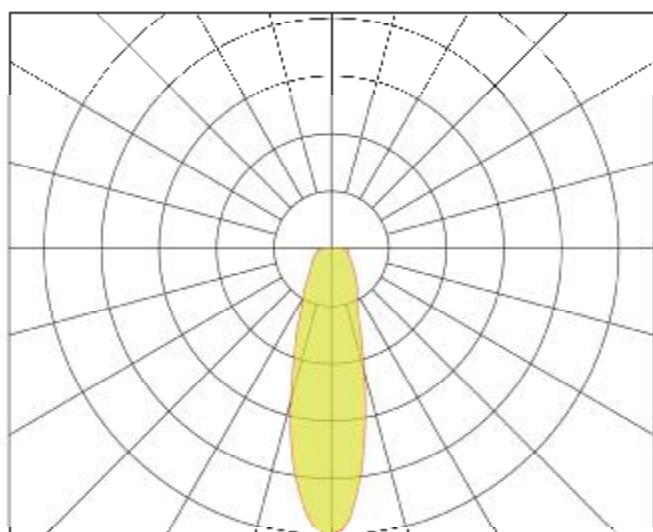

Note: The LED emitter flux is 120lm @350mA



2D Drawings (unit:mm)

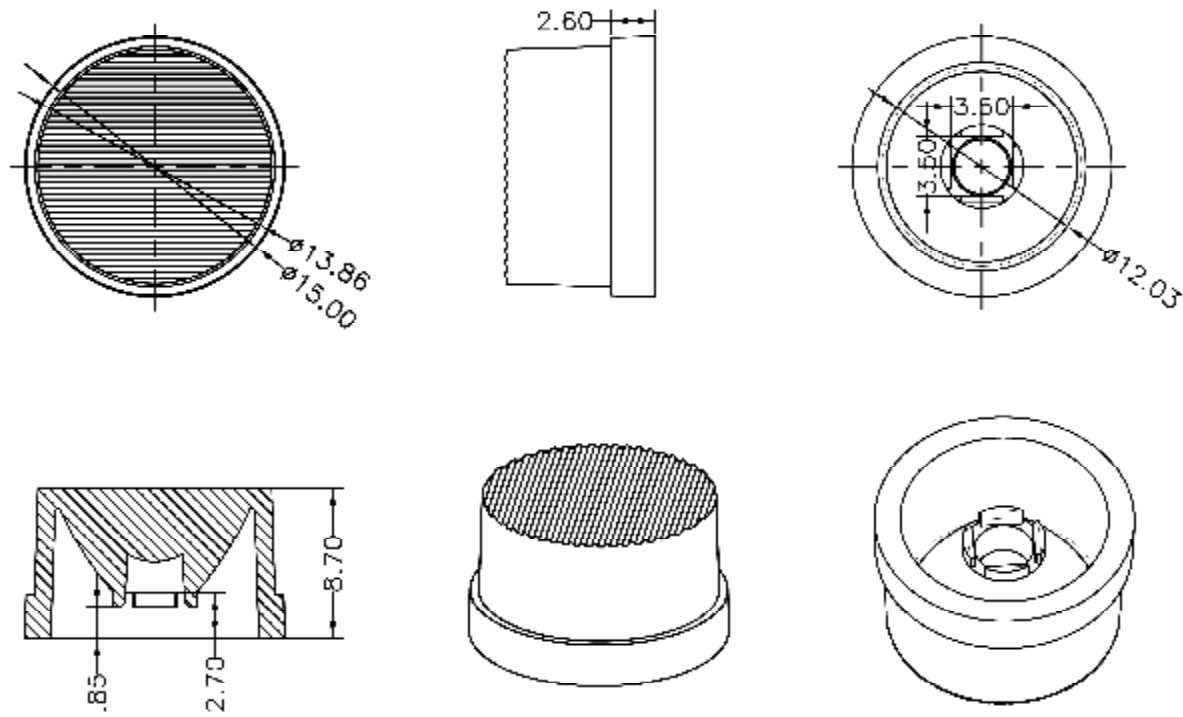

LENS

Optical Characteristics (for 3535 LED)

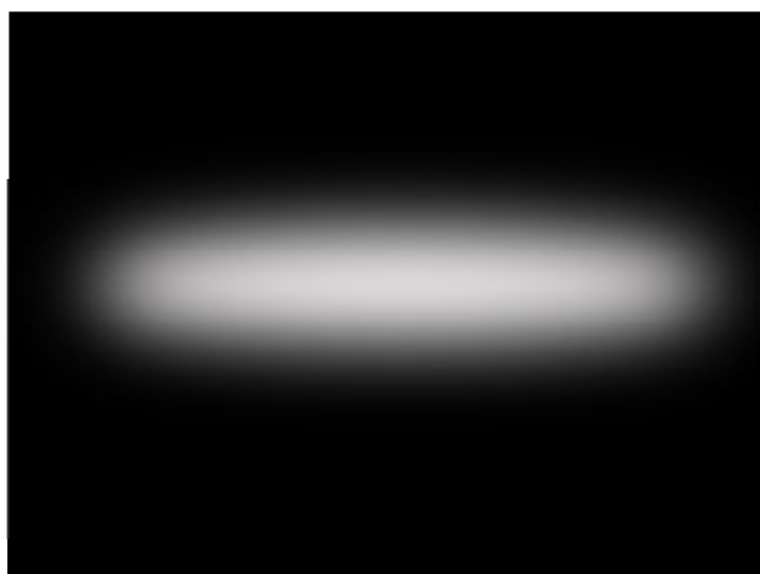
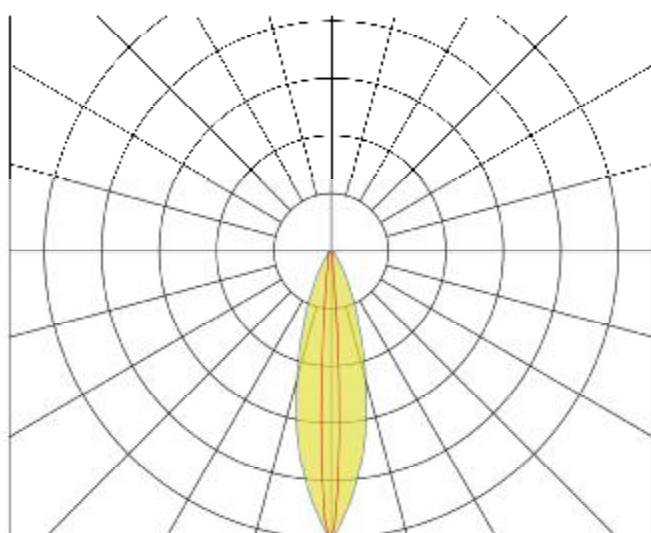

Note: The LED emitter flux is 120lm @350mA



2D Drawings (unit:mm)

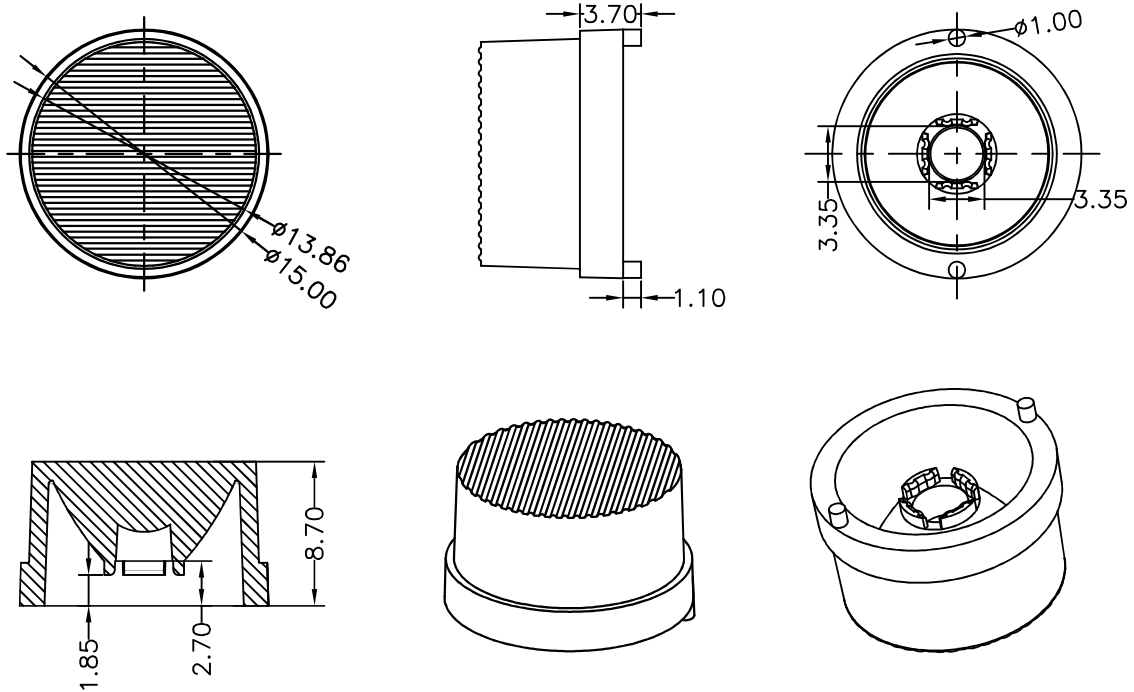

LENS

Optical Characteristics (for 3535 LED)

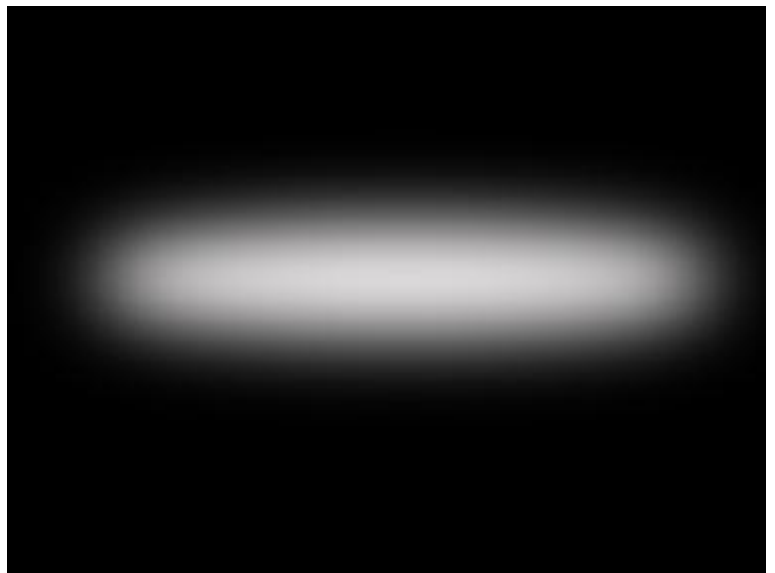
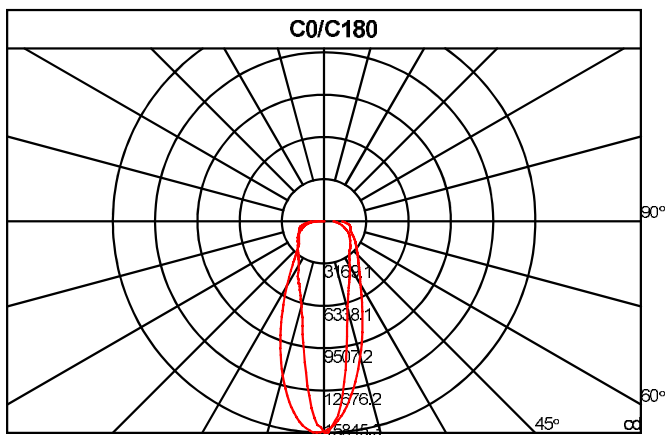

Note: The LED emitter flux is 120lm @350mA



Package Information

Item	Quantity	Total	Size (long*width* high)
Bag	800pcs/bag	800pcs	—
Inner box	1 bag /Inner box	800pcs	12.5*12.5*12.5 cm
Outer box	18 Inner box/bag	14400pcs	42.0*39.0*28.0 cm

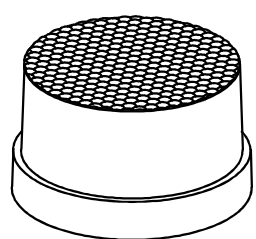

1pcs product

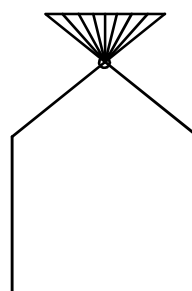

800pcs/Bag

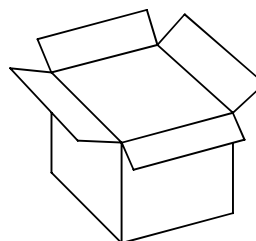

1bag/Inner box

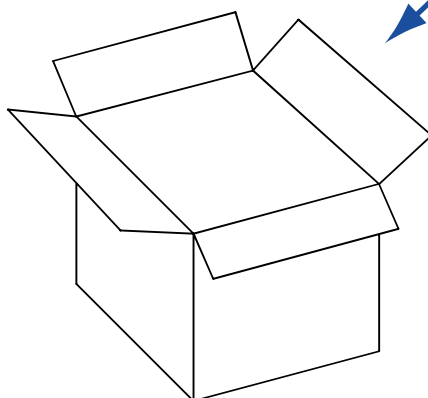

14400pcs /Outer box



Product Nomenclature

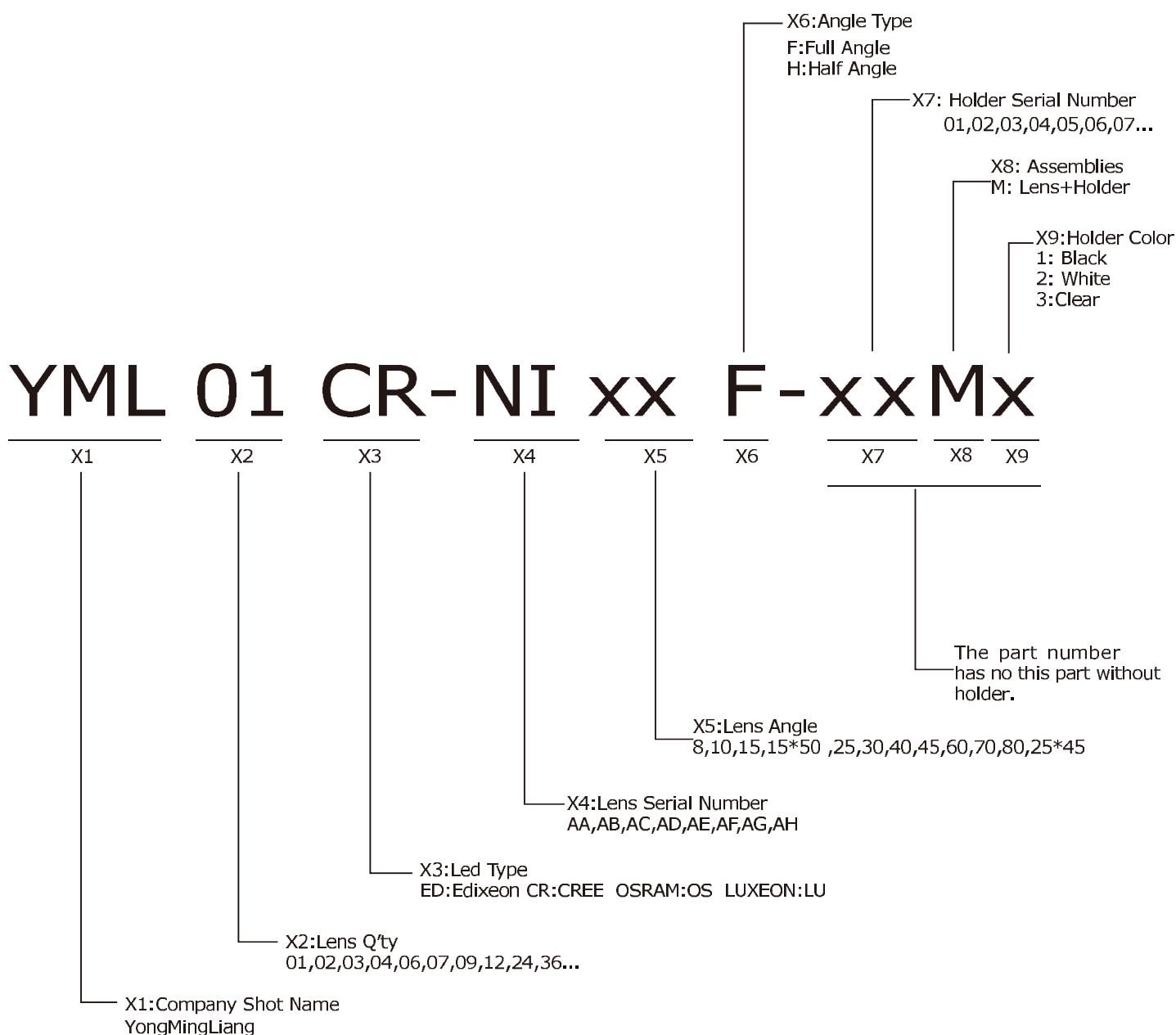



YML01CR-NIxxF LENS



PRODUCT DESCRIPTION

Features:

- High efficiency >88%
- Available in 4 beam pattern
- Optimized for uniform effects
- Lens material Optical grade PC
- Lens without holder

Typical applications:

- Stage Lighting
- Street Lights
- Decorative Light
- Down Light

TABLE OF CONTENTS

General Information	2
Usage and Maintenance	2
2D Drawings	3-7
Optical Characteristics (for 3535 led)	3-7
Package Information	8
Product Nomenclature	9



General Information (TJ = 25°C)

- Compatible Led Type:

The YML01CR-NIxxF single lens is optimized for 3535 led .

- Beam Angle Type:

An optimized profile integrate different front shape enabel the general of four lens model:oval beam (15deg;30deg;45deg and 10*65deg)⁽¹⁾

- The Way to Assembly:

The lens should be assembled to the PCB board or MCPCB upon LEDs which provides the most appropriate related position,so as to achieve the best uniform results.

*** Manually installation or if necessary thermal glue are recommended.**

- Fuction:

YML01CR-NIxxF provides excep tional color mixing result with the highest efficiency through careful enginnering and precision manufacturing process.

Usage and Maintenance

- 1.Clean lenses with mild soap and water and a soft cloth.
- 2.Don't use any commercial cleaning solvents on lenses,like alcohol.
- 3.Operating temperature -40℃~+110℃(upper limit +120℃)
- 4.please handle or install lenses with wearing gloves,skin oils may damage lens or optical characteristic.

Notes:

(1) Typical beam divergence will be affected by different LED manufacturers.



2D Drawings (unit:mm)

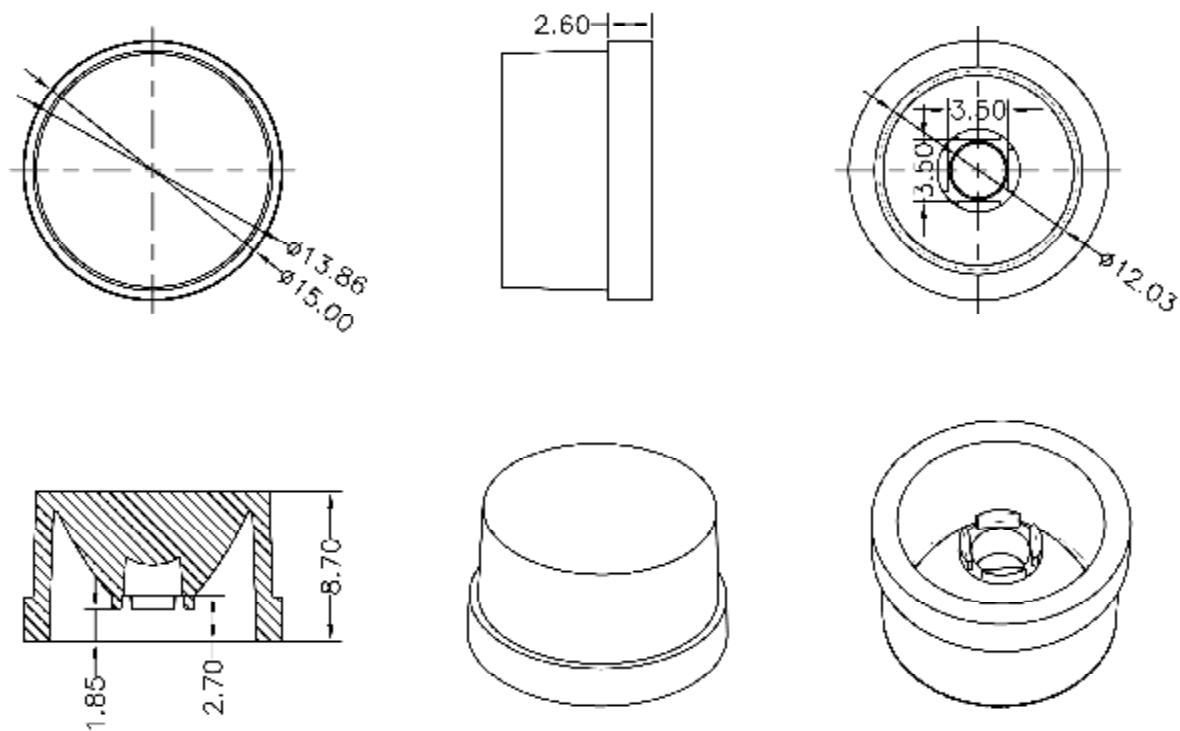

LENS

Optical Characteristics (for 3535 LED)

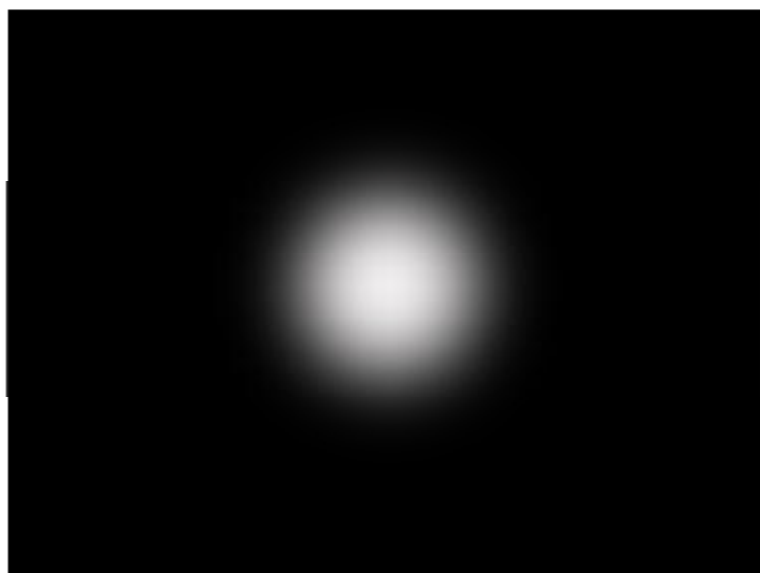
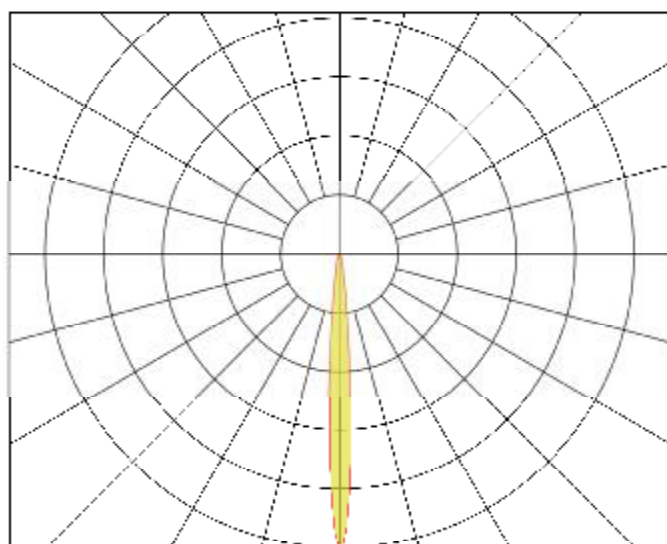

Note: The LED emitter flux is 120lm @350mA



2D Drawings (unit:mm)

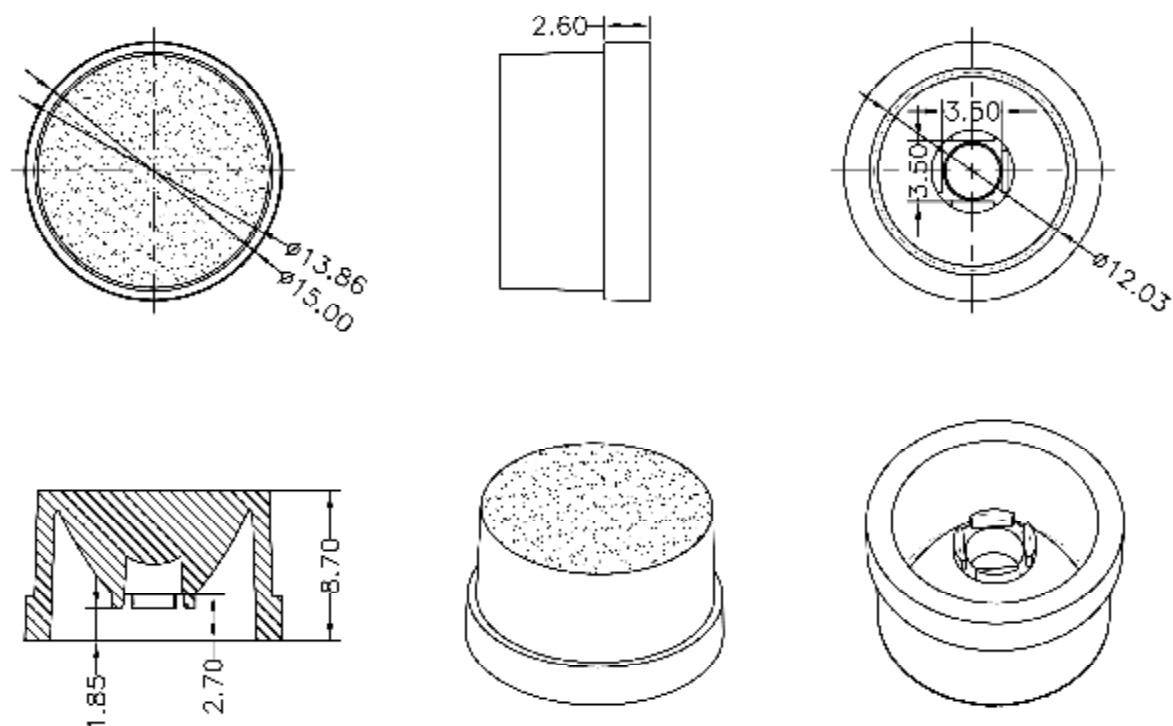

LENS

Optical Characteristics (for 3535 LED)

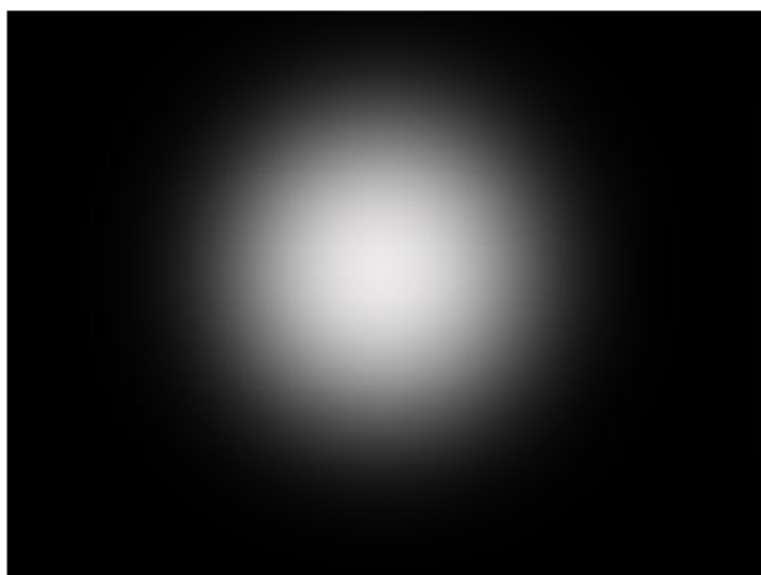
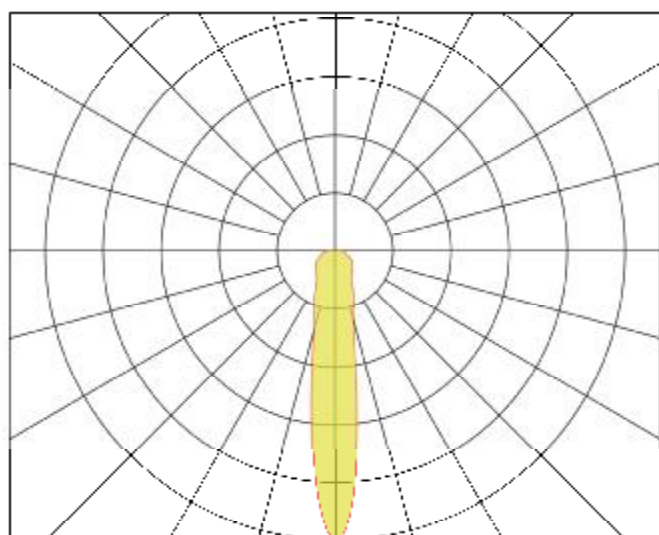

Note: The LED emitter flux is 120lm @350mA



2D Drawings (unit:mm)

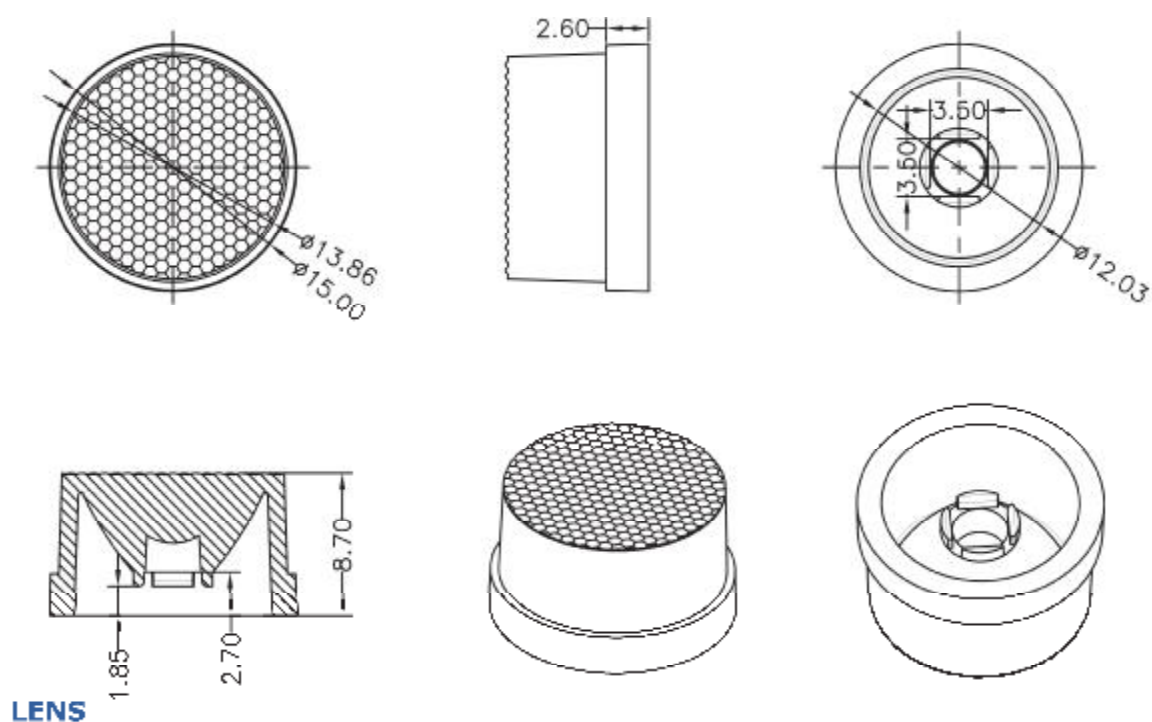

Optical Characteristics (for 3535 LED)

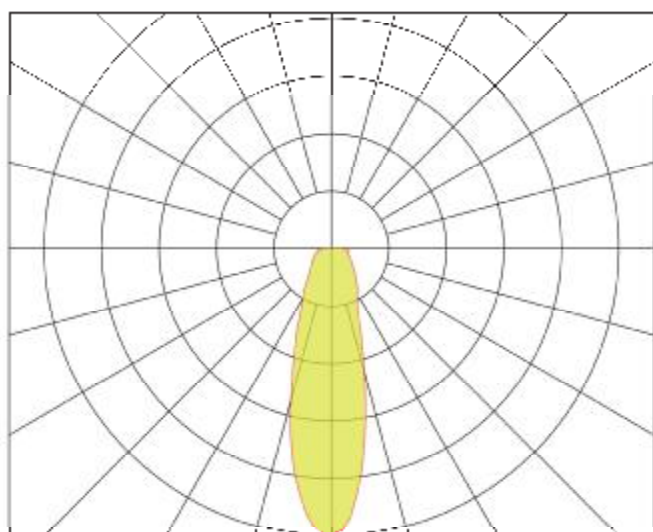

Note: The LED emitter flux is 120lm @350mA



2D Drawings (unit:mm)

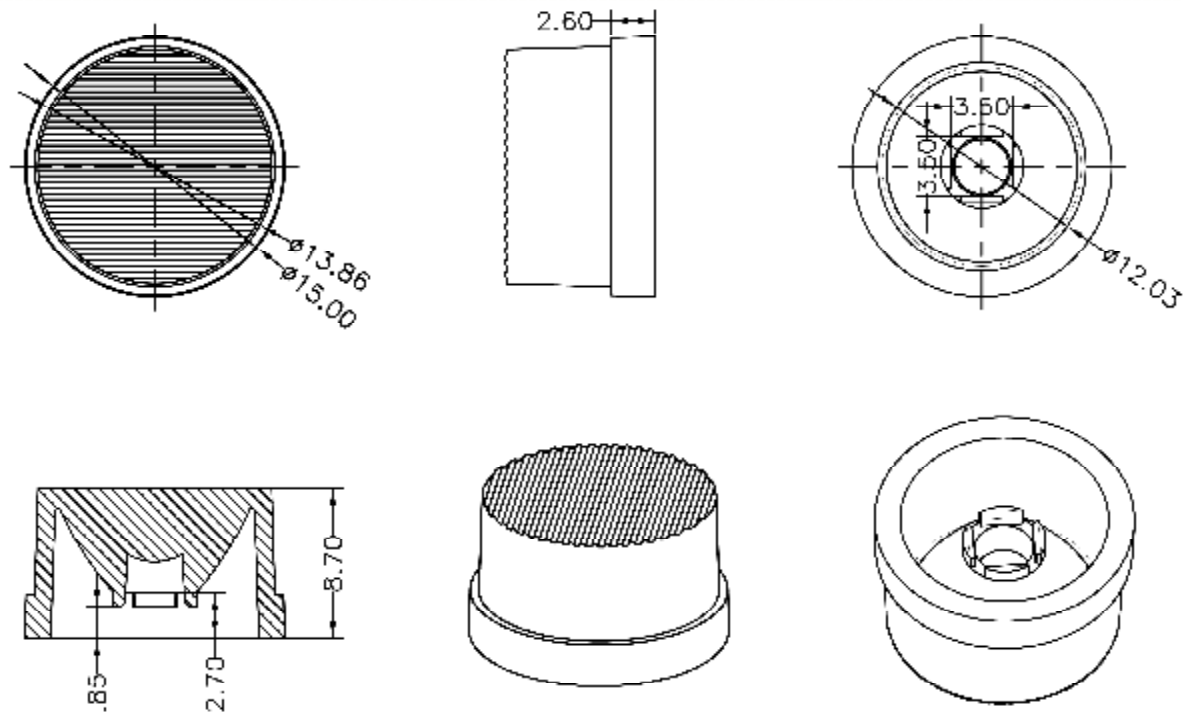

LENS

Optical Characteristics (for 3535 LED)

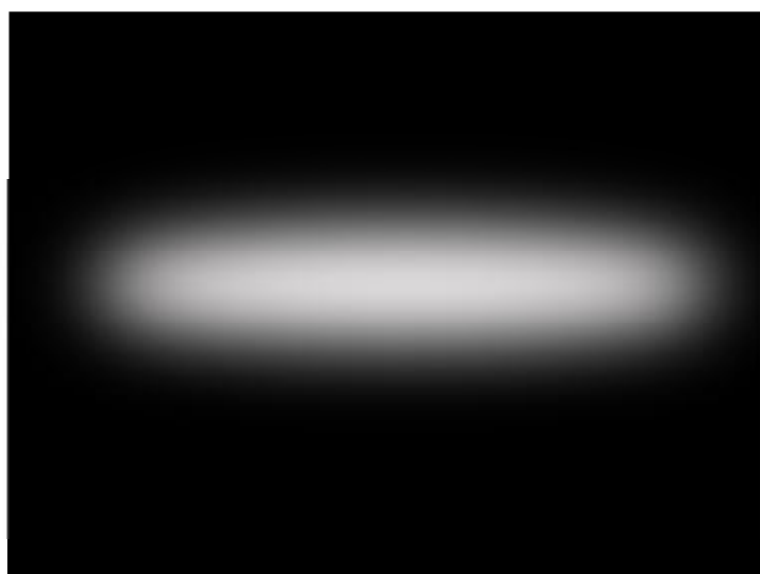
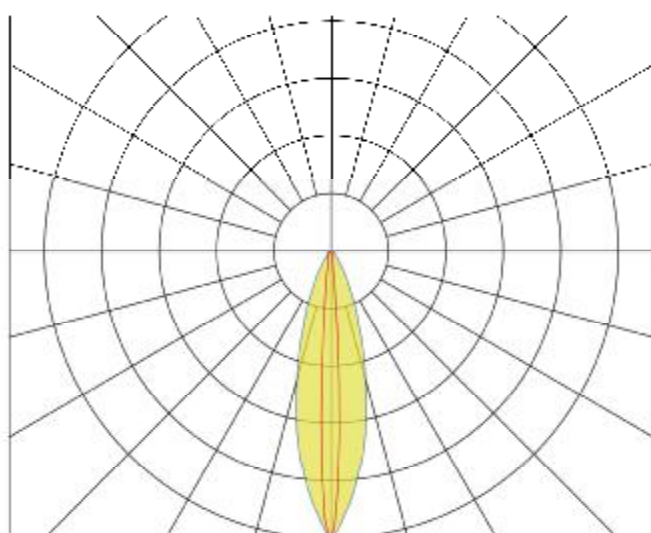

Note: The LED emitter flux is 120lm @350mA



2D Drawings (unit:mm)

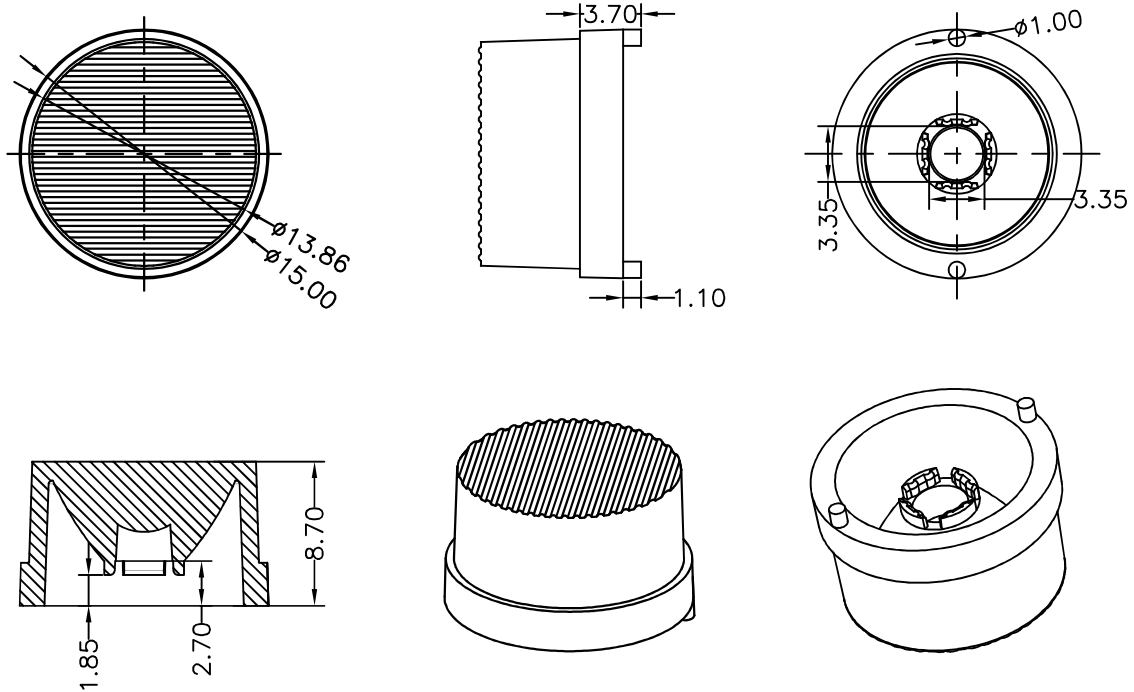

LENS

Optical Characteristics (for 3535 LED)

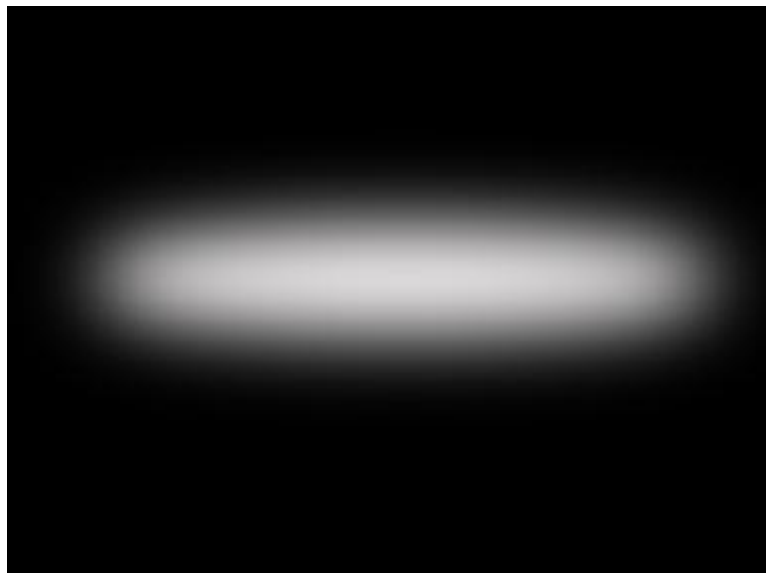
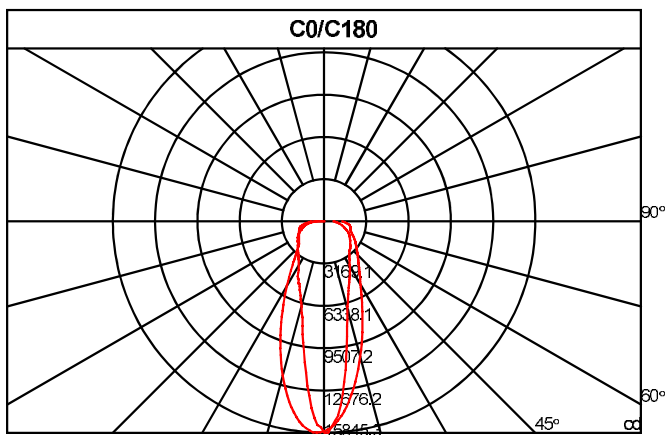

Note: The LED emitter flux is 120lm @350mA



Package Information

Item	Quantity	Total	Size (long*width* high)
Bag	800pcs/bag	800pcs	—
Inner box	1 bag /Inner box	800pcs	12.5*12.5*12.5 cm
Outer box	18 Inner box/bag	14400pcs	42.0*39.0*28.0 cm

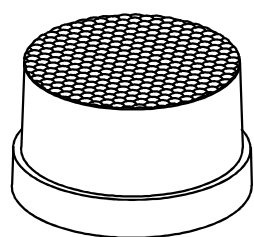

1pcs product

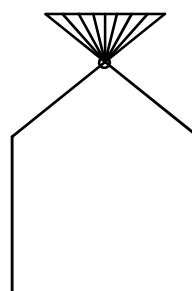

800pcs/Bag

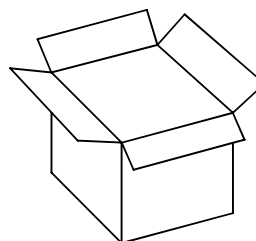

1bag/Inner box

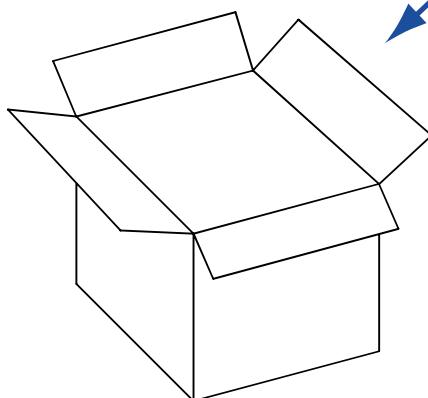

14400pcs /Outer box



Product Nomenclature

